





## **Accommodation**

### Ground Floor

#### Entrance Hallway

Half glazed entrance door, stairs rising to the first floor, central heating radiator, door into:

#### Lounge

Double glazed window to the front elevation, central heating radiator, wall mounted electric fire, door into under stairs storage cupboard, further door into:

#### Kitchen/Diner

A spacious kitchen/diner fitted with a range of modern wall and base units with contrasting rolled edge work surfaces and tiled splashbacks, stainless steel electric oven with four ring gas hob and stainless steel extractor hood over, space and plumbing for washing machine, stainless steel sink with mixer tap, wall mounted Worcester combination boiler, double glazed window to rear and half glazed door leading to the rear garden.

### First Floor

#### Landing

Loft access hatch, door into:

#### Bedroom 1

Double glazed window to the front elevation with open views, central heating radiator, door into over stairs storage cupboard.

#### Bedroom 2

Double glazed window to the rear elevation, central heating radiator.

#### Bathroom

Part tiled and fitted with a white three piece suite, comprising wash hand basin, toilet and bath with shower and glazed shower screen over, chrome heated towel rail, frosted double glazed window to rear.

#### Outside

To the front of the property there is a raised graveled garden, with steps leading to the front door.

A pathway leads down the side of the property and gives access to the rear garden.

The rear garden is fully enclosed with fenced boundaries, the garden is paved and gravelled for ease of maintenance, whilst also offering a high level of privacy. The garden runs down the side of the property, which creates a handy storage area.





Floorplan

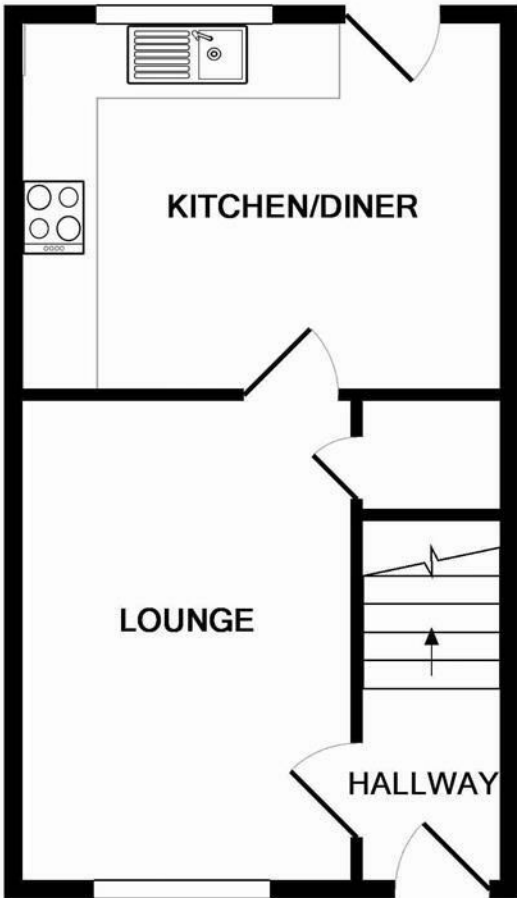

GROUND FLOOR

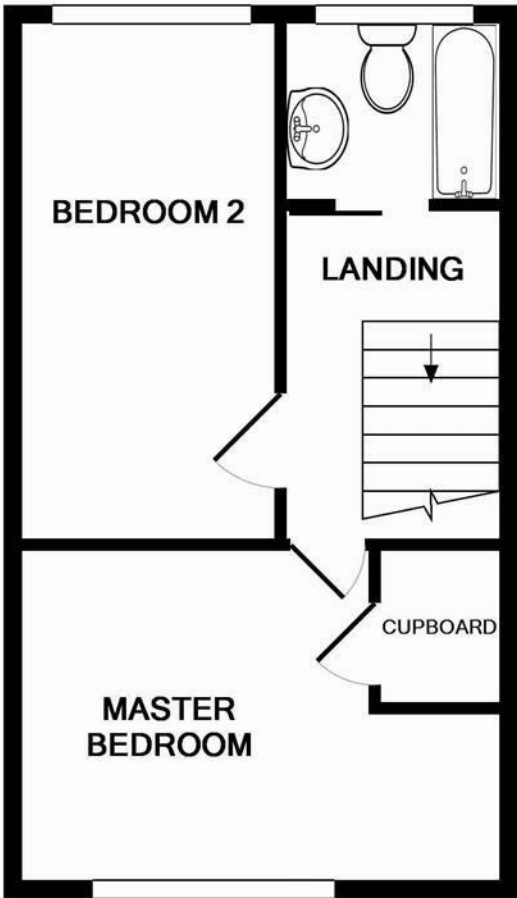

1ST FLOOR

Whilst every attempt has been made to ensure the accuracy of the floor plan contained here, measurements of doors, windows, rooms and any other items are approximate and no responsibility is taken for any error, omission, or mis-statement. This plan is for illustrative purposes only and should be used as such by any prospective purchaser. The services, systems and appliances shown have not been tested and no guarantee as to their operability or efficiency can be given  
Made with Metropix ©2016



## EPC

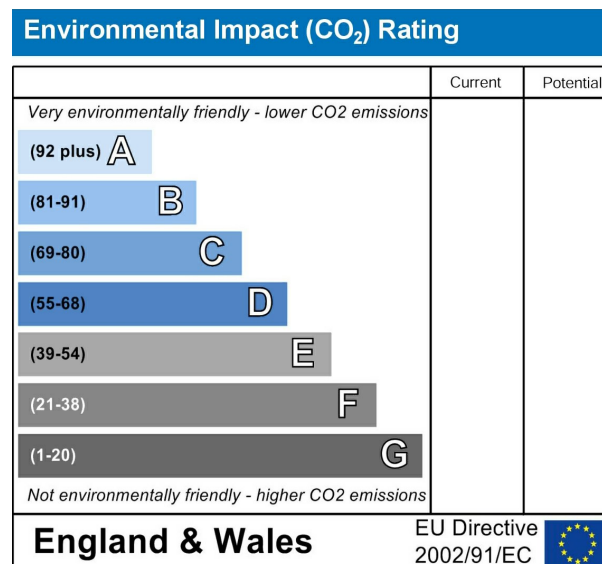
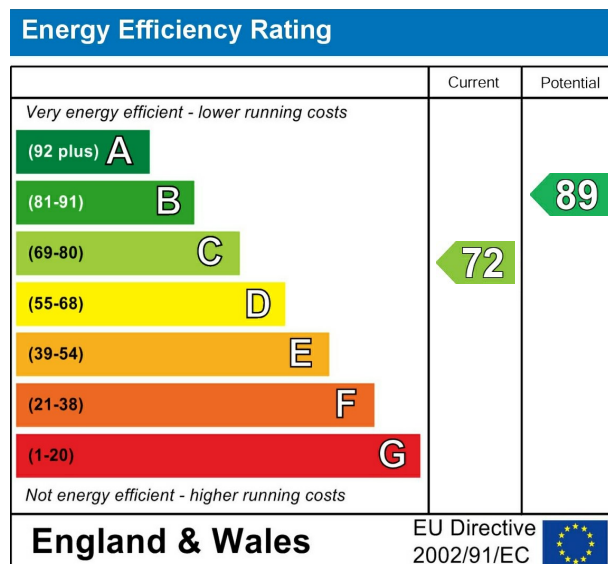

VIEWING BY APPOINTMENT ONLY - 01765 602233 - [sales@davislund.co.uk](mailto:sales@davislund.co.uk) - [www.davislund.co.uk](http://www.davislund.co.uk)

**MONEY LAUNDERING REGULATIONS 2003** - Intending purchasers will be asked to produce identification and proof of financial status when an offer is received. We would ask for your co-operation in order that there will be no delay in agreeing the sale.

Davis & Lund Ltd trading as Davis & Lund, registered office: 5a Kirkgate, Ripon, HG4 1PA. Registered in England No 10034416. Registered for VAT No 243 2008 51

Davis & Lund Ltd have prepared these property details on the seller's behalf. Davis & Lund Ltd have taken reasonable steps to check the content, but no information should be taken as a statement of fact. All measurements are approximate and should be taken as a guide, potential purchasers should satisfy themselves as to the accuracy. Floorplans are produced as a guide and they are not to scale. All fixtures and fittings are not included in the sale, unless stated. Heating systems, electrics, services and appliances have not been tested and no warranty is given to their working order

